



Farmers Electric Cooperative

A Touchstone Energy Cooperative

301 N. Hillcrest
Sulphur Springs, TX 75482

2000 I-30 E
Greenville, TX 75402

108 W. Marble
Wylie, TX 75098

Friday, April 5, 2019

Office of Hopkins County Judge
PO Box 288
Sulphur Springs TX 75483

Farmers Electric Cooperative Member: DAVID FRONEBERGER
Service Order Number: 1903002624

Greetings:

Farmers Electric Cooperative, Inc. is requesting permission to construct electrical power distribution facilities which will cross County Road 3520 which is located, 11650 ft southeast of CR 3518 in Hopkins County, Texas.

Site location map and construction sketches are enclosed. The construction sketch details the proposed work. All road crossings will have a minimum vertical clearance of 22 feet.

If you have any questions, please contact me at any time.

Sincerely,

Matthew Walker

Project Coordinator
mwalker@farmerselectric.coop
Phone 903-441-1368

Submitted by Brandon Darrow
bdarrow@farmerselectric.coop
Field Engineering Coordinator

Enclosures

County Approval Section:

Approved: ☒

Denied: ☐

Authorized Signature: Wade Burtley

Date: 4-18-19

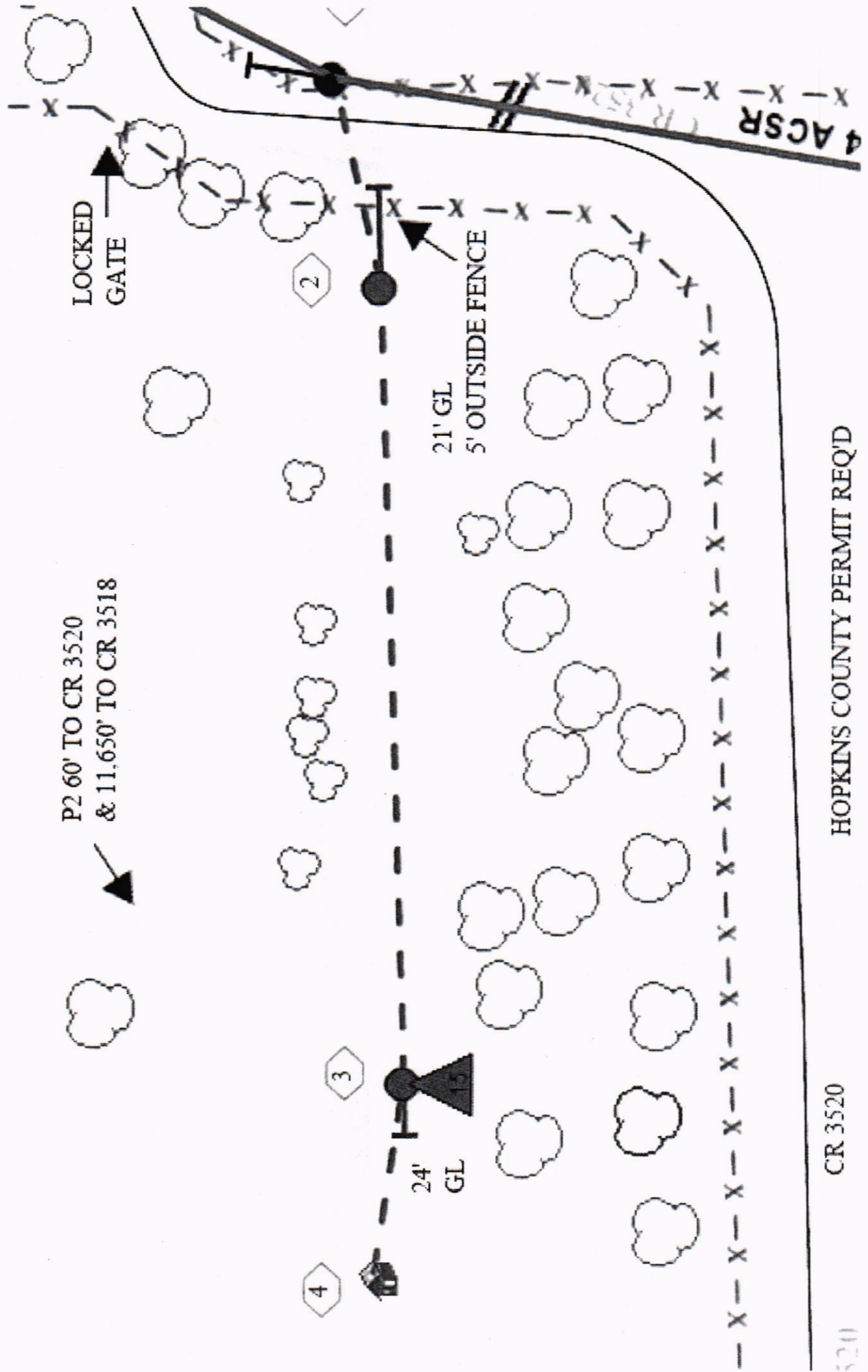

HOPKINS COUNTY PERMIT REQ'D

CR 3520

David Froneberger
Service Order#
1903002624
Cross CR 3520 at
Pole#090578.

County Road 3520

